



## GSC1-4011FC ~ 6511FC 防尘交流接触器

### GSC1-4011FC ~ 6511FC Range Dust AC Contactor

#### 一、用途 APPLICATION

GSC1-4011FC ~ 6511FC 防尘交流接触器(以下简称接触器)主要用于交流 50Hz(或60Hz), 额定绝缘电压690V, 额定工作电压至660V, 在AC-3使用类别下额定工作电压为380V时额定工作电流为40A ~ 65A的电路中, 供远距离接通和分断电路, 并可与适当的热过载继电器组成电磁起动器以保护可能发生过载的电路。能够适用于工作条件恶劣, 环境粉尘较大, 要求产品防尘性能高的行业, 如电焊机行业、纺织行业、水泥厂、面粉加工厂等。

GSC1-4011FC ~ 6511FC range dust AC contactor is used in AC 50Hz (or 60Hz), rated isolation voltage up to 690V, and rated current 40A ~ 65A under rated voltage 380V and category AC-3 circuit, for long-distance making and breaking circuit, and can interoperable with the appropriate thermal overload relay comprising electromagnetic starter for protecting potential overload circuit. Adapt poor working conditions, larger environmental dust; require high-performance of dust industry, such as welding machine industry、the textile industry、cement factory、flour processing plants and so on.

#### 二、型号及含义 TYPE AND MEANING



表(table)1

型号 type	电源频率Hz Power frequency	线圈电压V coil voltage					
		24	48	110	200	220	380
GSC1-4011FC ~ 6511FC	50/60	B7	E7	F7	LC	M7	Q7

- △ 如需其它电压规格可特殊订货。  
If need other product, can specially customize.

#### 三、结构特点 STRUCTURE FEATURE

- △ 动作机构为直动式、触头为双断点；  
Direct-moving, double breaking contact terminals;
- △ 两侧可加装联锁机构；Can added reverse device on both sides;
- △ 上方可加装辅助触头组 (F3-d) 或空气延时头 (SK4-2/3d) ；  
Can added auxiliary contact arrangement (F3-d) or air time-delay (Sk4-2/3d) ；
- △ 线圈上可加装延时模块、放大模块和过电压抑制器等功能模块。  
Can added time-delay module、expanding module、over-voltage

suppressor and other function model.

注:上方加装空气延时头时需特殊订货说明。

Note: if need add air time-delay terminal, need specially customize

#### 四、工作条件和安装条件 WORKING CONDITION AND INSTALLATION CONDITION

- △ 周围空气温度-5℃ ~ +40℃; 24小时内平均温度不超过+35℃;  
Ambient temperature: -5℃ ~ +40℃; the average temperature ≤ +35℃ in 24h
- △ 安装地点海拔不超过2000m; elevation ≤ 2000m
- △ 空气相对湿度在周围最高温度为+40℃时, 不超过50%, 在较低温度下可以有较高的相对温度, 最湿月的平均最大相对湿度不超过90%, 同时该月的月平均最低温度不超过+25℃, 并考虑因温度变化发生在产品表面上的凝露;  
Relative humidity is not exceeding 50% at the maximum ambient temperature +40℃. With lower temperature, higher humidity would be permitted. And average maximum relative humidity ≤ 90% in the most humidity month, at the same time, the average minimum temperature should ≤ +25℃, and should give consideration to dews on the goods surface, which would appear due to temperature change;
- △ 污染等级为“污染等级3”; Pollution grade: Grade 3;
- △ 安装类别为“安装类别Ⅲ”; Installation categories: class Ⅲ
- △ 防护等级为IP50; Protection grade: IP50
- △ 安装方式为“螺钉安装”。Installation way: by screw.

#### 五、规格 CHARACTER

■ 接触器规格见表2 contactor character as table 2

表(table)2

型号 type	额定工作电流A (AC-3 380V) Rated work current	控制功率KW (AC-3使用类别) Control power					触头数量 Contact volume
		220V	380V	415V	440V	660V	
GSC1-4011FC	40	11	18.5	22	22	30	3P+NO+NC
GSC1-5011FC	50	15	22	25	25	33	
GSC1-6511FC	65	18.5	30	37	37	37	

3P: 三对常开主触头 NO: 一对常开辅助触头 NC: 一对常闭辅助触头

3P: three pair normally open main contact NO: one pair normally auxiliary contact NC: one pair normal close auxiliary contact.

■ 附件规格 accessory character

- △ F3-d辅助触头组(见表3) F3-d auxiliary contact (as table 3)
- △ SK4-2/3d空气延时头(见表4) SK4-2/3d air time-delay (as table4)

表(table)3

型号 type	触头数量 contact volume
F3-11d <sub>2</sub>	1NO+1NC
F3-20d <sub>2</sub>	2NO
F3-02d	2NC
F3-22d	2NO+2NC
F3-40d	4NO
F3-04d	4NC
F3-31d	3NO+1NC
F3-13d	1NO+3NC

表(table)4

型号 type	延时范围 time-delay area S	延时触头数量 Time-delay contact volume	备注 remark
Sk4-220d	0.1~3	1NO+1NC	通电延时 Making time-delay
Sk4-222d	0.1~30		
Sk4-224d	10~180		
Sk4-320d	0.1~3		断电延时 Breaking time -delay
Sk4-322d	0.1~30		
Sk4-324d	10~180		

## 六、技术参数 TECHNICAL PARAMETERS

型号 type		GSC1-4011FC	GSC1-5011FC	GSC1-6511FC	
额定工作电流 I <sub>e</sub> A (AC-3) Rated working current	380V	40	50	65	
	660V	34	39	42	
约定发热电流 I <sub>th</sub> A conventional thermal current		60	80	80	
额定工作电压 U <sub>e</sub> V Rated working voltage		380、660	380、660	380、660	
额定绝缘电压 U <sub>i</sub> V Rated insulation voltage		690	690	690	
AC-3 (6I <sub>e</sub> , I <sub>e</sub> )	电寿命 10 <sup>4</sup> 次 life span of trip	50	50	50	
	操作频率 h <sup>-1</sup> Operation frequency	600	600	600	
AC-3 (6I <sub>e</sub> , 6I <sub>e</sub> )	电寿命 10 <sup>4</sup> 次 life span of trip	15	15	15	
	操作频率 h <sup>-1</sup> Operation frequency	150	150	150	
	额定工作电 流 I <sub>e</sub> : A Rated working current	380V	18.5	24	28
		660V	9	12	14
辅助触头 Auxiliary contact	约定发热电流 A Conventional thermal current		10		
	电寿命 Life span	AC-15 (360VA)	同主触头电寿命 (AC-3) With the main electrical contact life (AC-3)		
		DC-13 (33W)			
可接通最小负载 Connect minimum load		24V、10mA			
线圈 Coil character	额定控制电源电压 U <sub>s</sub> V Rated control voltage		24、48、110、200、220、380		
	吸合电压 pull voltage		0.85U <sub>s</sub> ~ 1.1U <sub>s</sub>		
	释放电压 release voltage		0.2U <sub>s</sub> ~ 0.75U <sub>s</sub>		
	线圈功率 wiring power VA 50/60Hz	吸合 pull		230	
		保持 contain		26	
机械寿命 10 <sup>4</sup> 次 Machinery life span of trip times		500			

## 七、外形和安装尺寸 OUTLINE DIMENSIONS AND MOUNTING DIMENSIONS

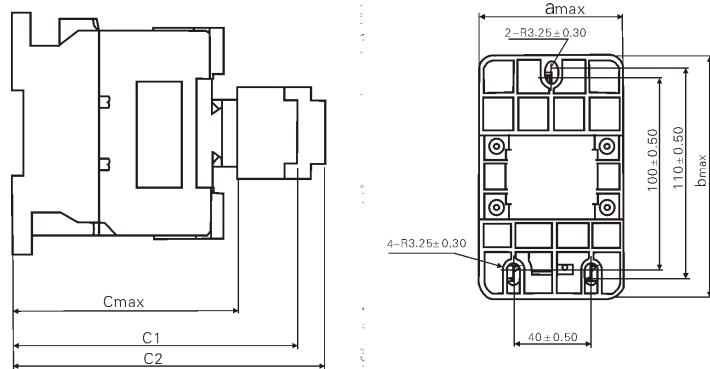

注(Remark): C1:GSC1+F3-d  
C2:GSC1+SK4-d

接触器型号 contactor type	amax	bmax	Cmax	C1	C2
GSC1-4011FC、5011FC、6511FC	75	128	118	151	170

## 八、接线图 WIRING PICTURE

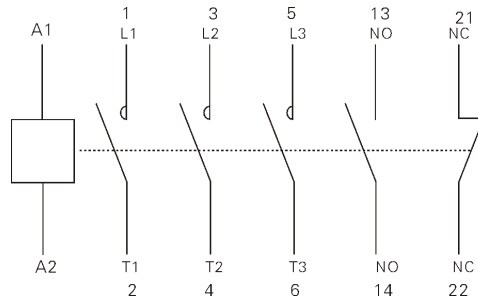

## 九、订货须知 ORDER REMARK

- 在订货时须写明以下内容 In order need attention following:
  - △ 接触器的全型号及名称; Entitle type and name of contactor;
  - △ 控制线圈的电压及频率; Frequency and Voltage of control coil;
  - △ 订购数量: Order volume:
    - 例如: GSC1-4011FC M7防尘交流接触器 220V 50Hz/60Hz 10台;
    - Example: GSC1-4011FC M7 dust AC contactor 220V 50Hz/60Hz 10sets
  - 表示为40A防尘交流接触器, 辅助触头为1常开和1常闭, 控制线圈电压220V, 频率为50Hz/60Hz, 订货数量为10台;
  - Means: need dust AC contactor, 40A, auxiliary contact is one pair normally open and one pair normally closed, control coil voltage 220V, frequency 50Hz/60Hz, order specially customize.
- △ 特殊电压规格产品, 如用户需要可特殊订货。
  - If need special voltage character product, can specially customize.